



White Pass & Yukon Route
Alco 101 – 110
DL-535E
On3 / ¼" Scale

UPDATE

Date	Location	Description
2015-10-01	Trucks	First STL parts from arrived (white and grey)



White Pass & Yukon Route

Alco 101 – 110

DL-535E

On3 / ¼" Scale



First sample in On3 scale from rapid prototype material.



Original at Skagway. Was rebuilt in 2015 and now in use.



White Pass & Yukon Route

Alco 101 – 110

DL-535E

On3 / ¼" Scale



On3 Sample with Bolster and equalizer bar in different stage.



White Pass & Yukon Route

Alco 101 – 110

DL-535E

On3 / ¼" Scale





White Pass & Yukon Route

Alco 101 – 110

DL-535E

On3 / ¼" Scale





White Pass & Yukon Route
Alco 101 – 110
DL-535E
On3 / ¼" Scale

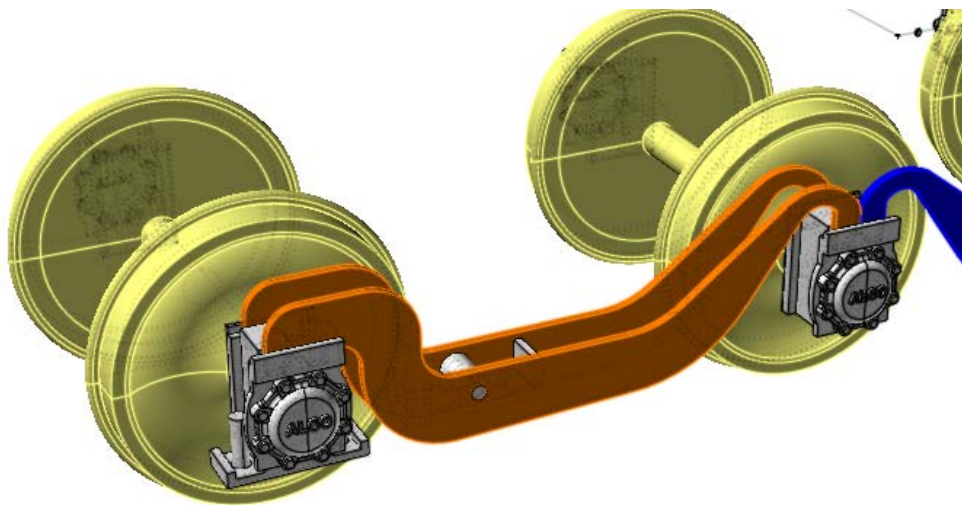
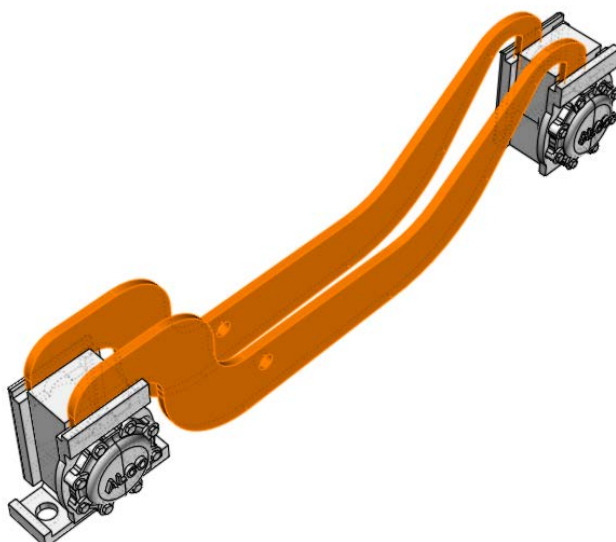
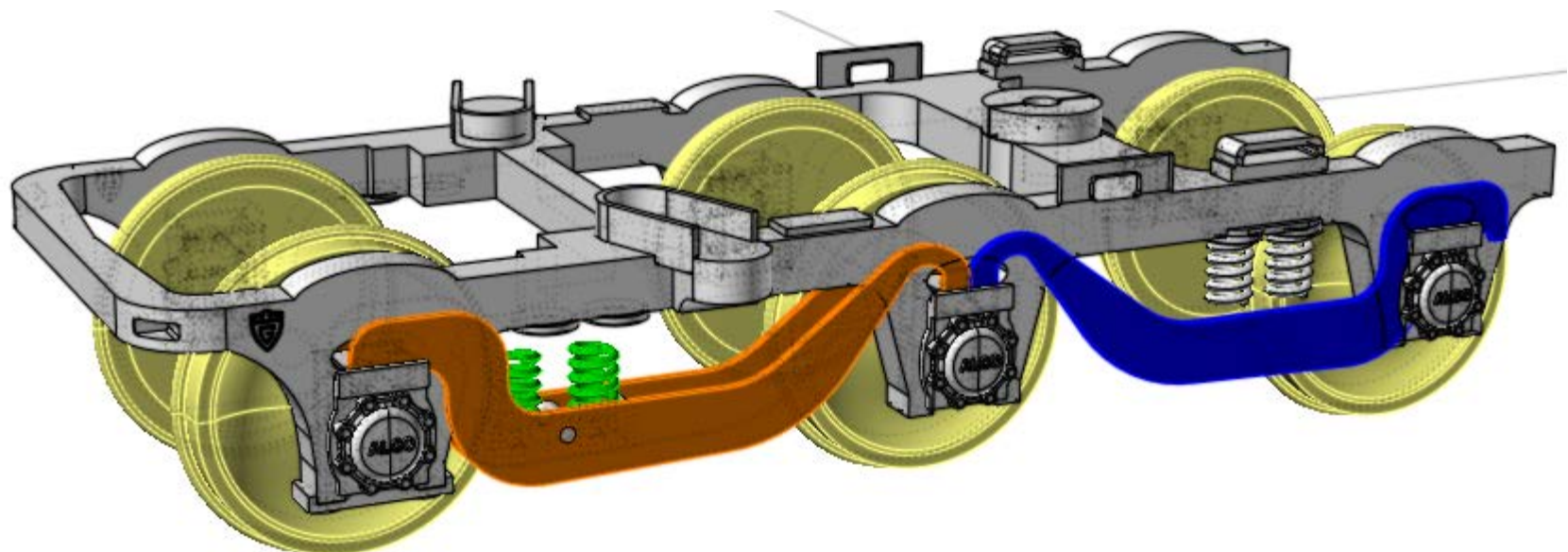



White Pass & Yukon Route

Alco 101 – 110

DL-535E

On3 / ¼" Scale

Run DCC with
Sound
ESU decoder.

Motor

Transfer Gear Box
(NWSL 221-6)

Gear Box
(NWSL)

Roller bearings
4 x 2 x 2 mm

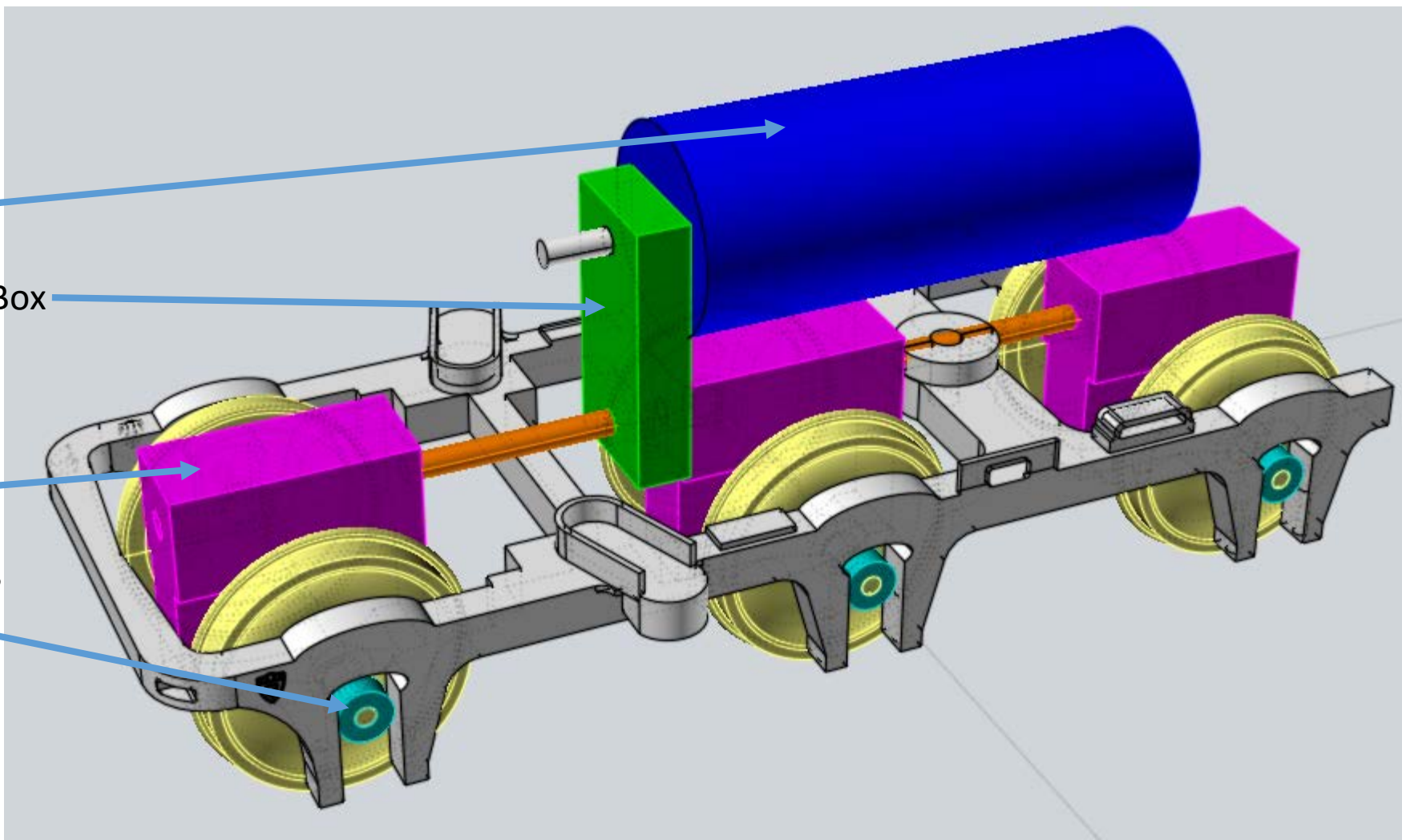



White Pass & Yukon Route
Alco 101 – 110
DL-535E
On3 / ¼" Scale

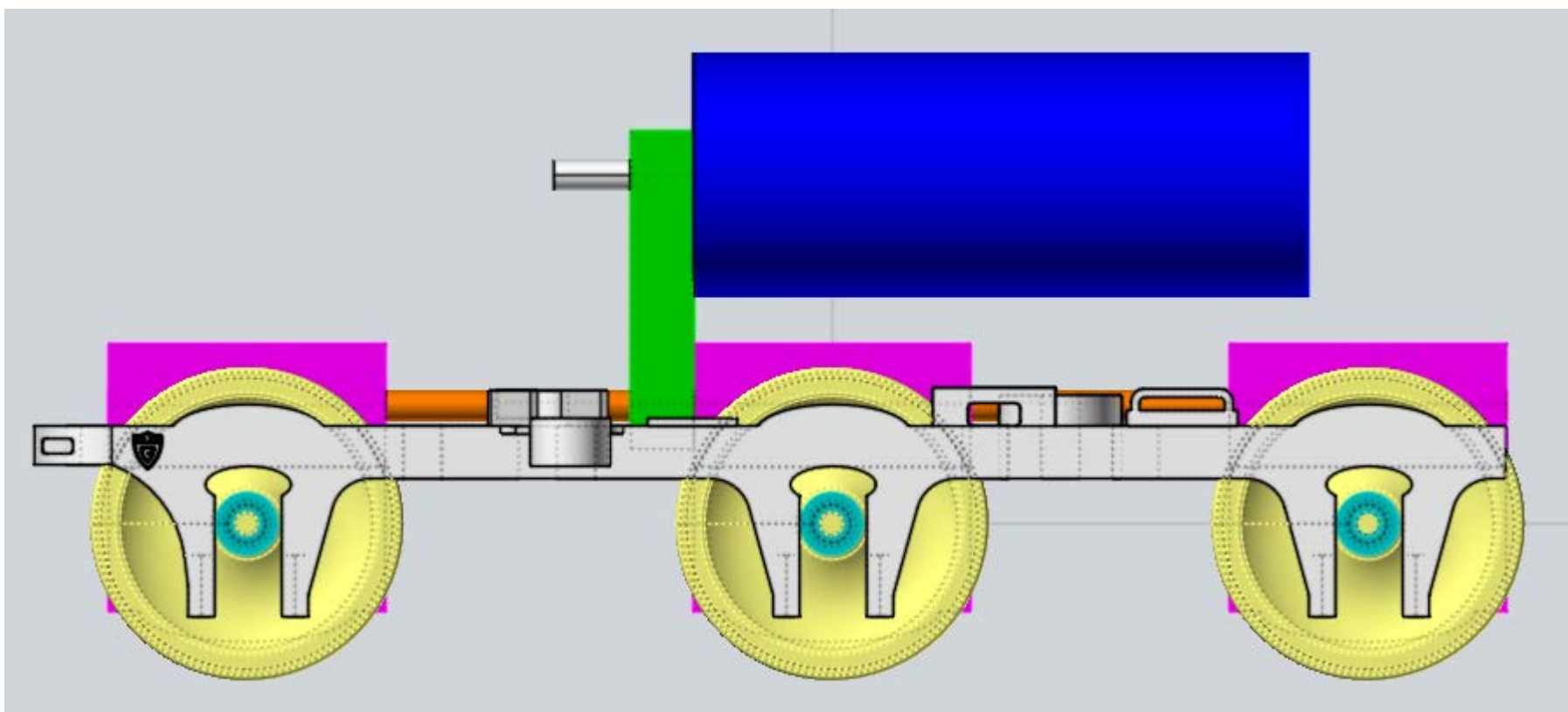

72 inch / 38,1 mm 66 inch / 34,9 mm



White Pass & Yukon Route

Alco 101 – 110

DL-535E

On3 / ¼" Scale

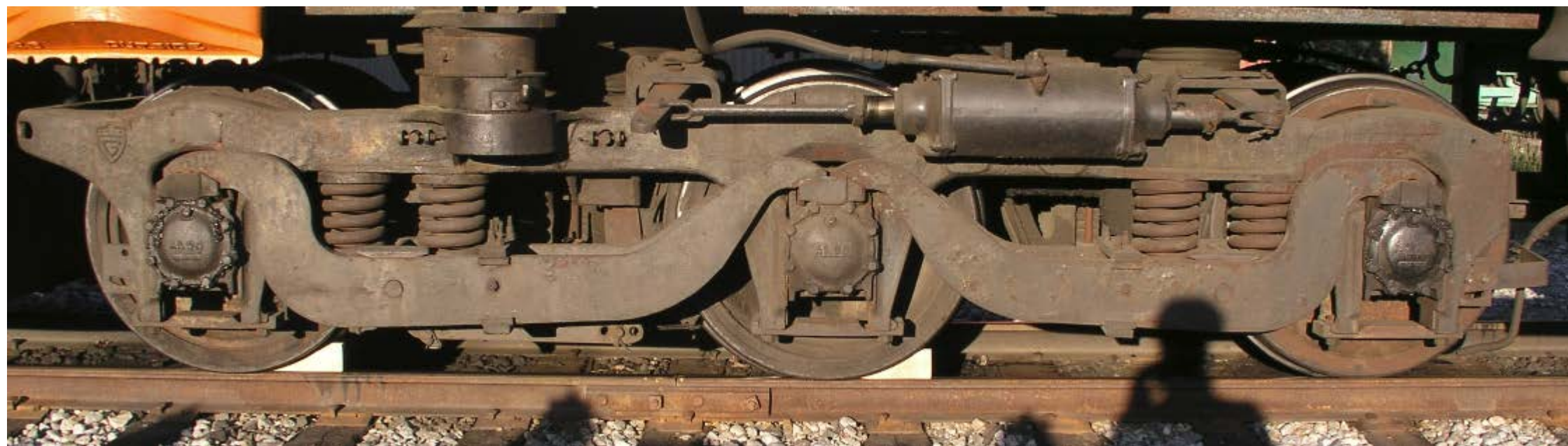



White Pass & Yukon Route

Alco 101 – 110

DL-535E

On3 / ¼" Scale

FRAME UPDATE

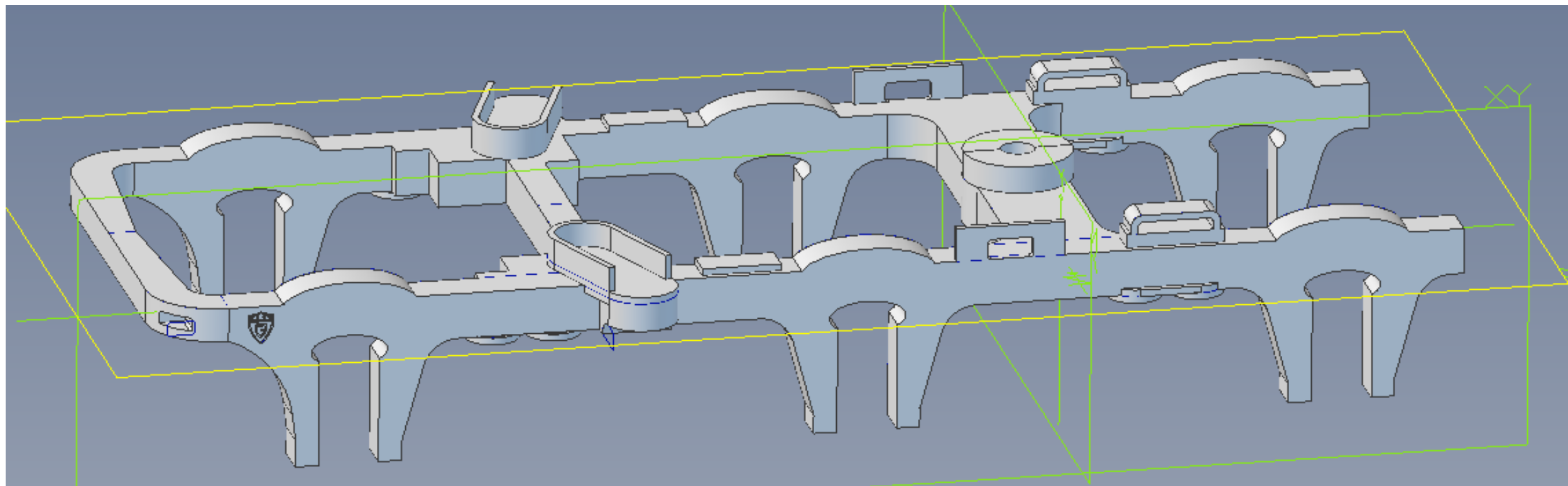



White Pass & Yukon Route

Alco 101 – 110

DL-535E

On3 / ¼" Scale

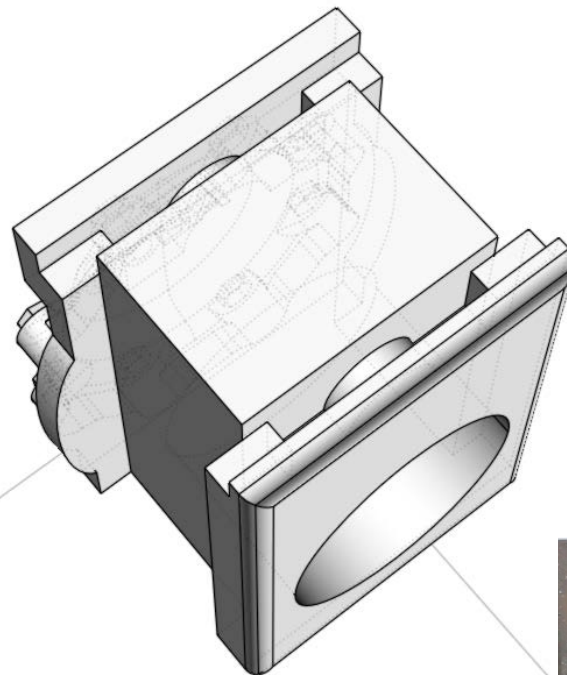
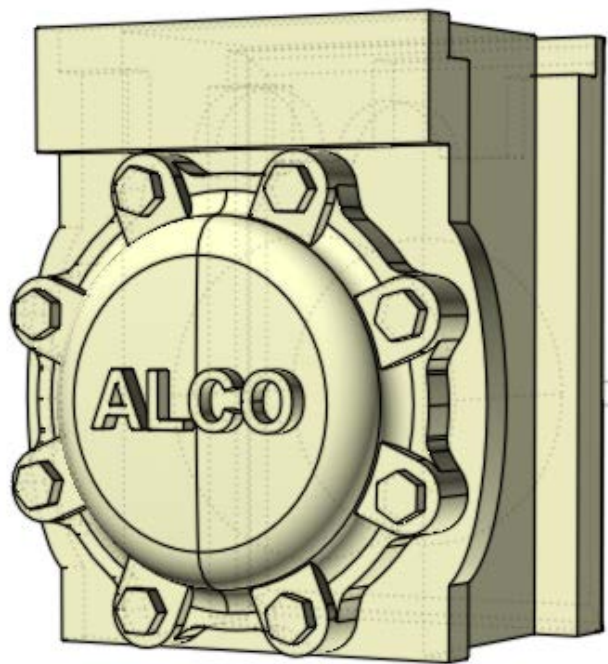

Original Scale 1:48

Height 6 mm

Wide 5,4 mm

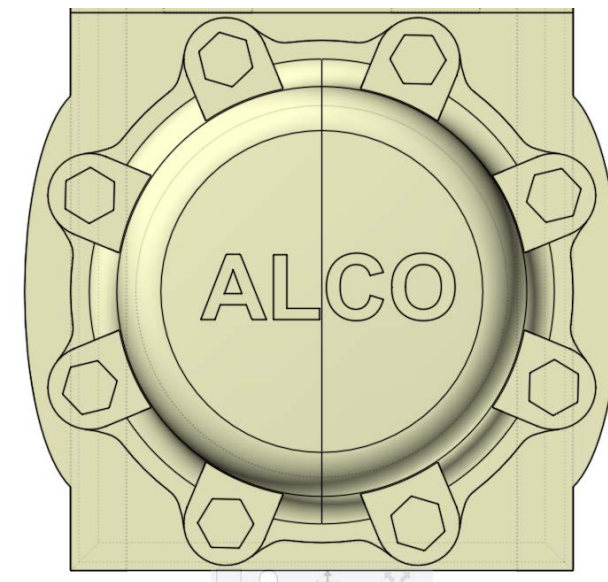
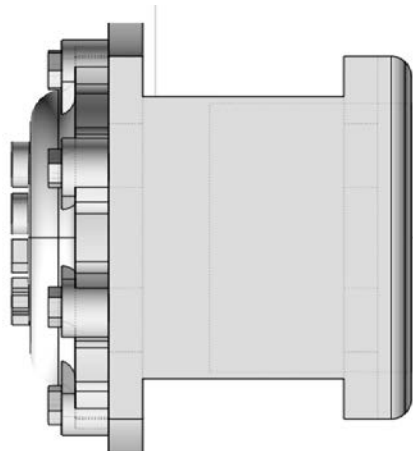
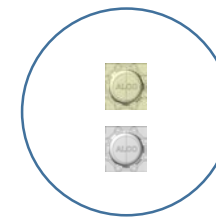



White Pass & Yukon Route

Alco 101 – 110

DL-535E

On3 / ¼" Scale

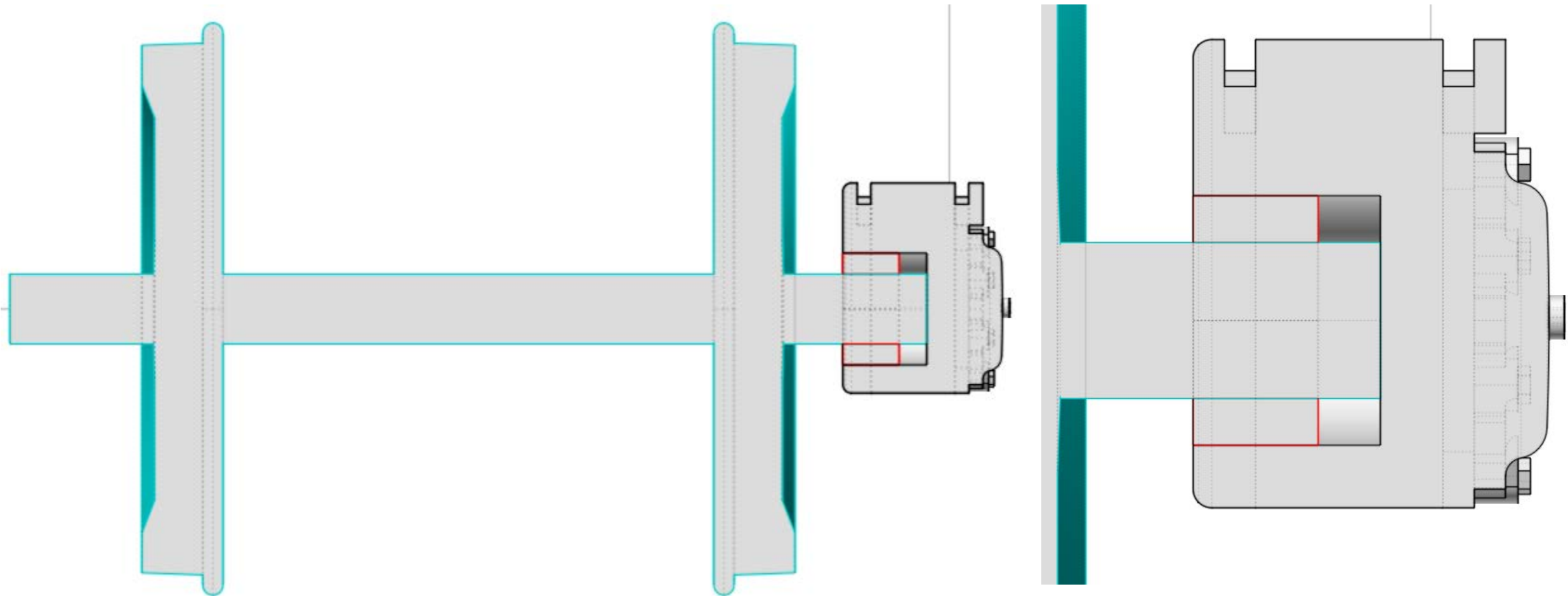



White Pass & Yukon Route
Alco 101 – 110
DL-535E
On3 / ¼" Scale

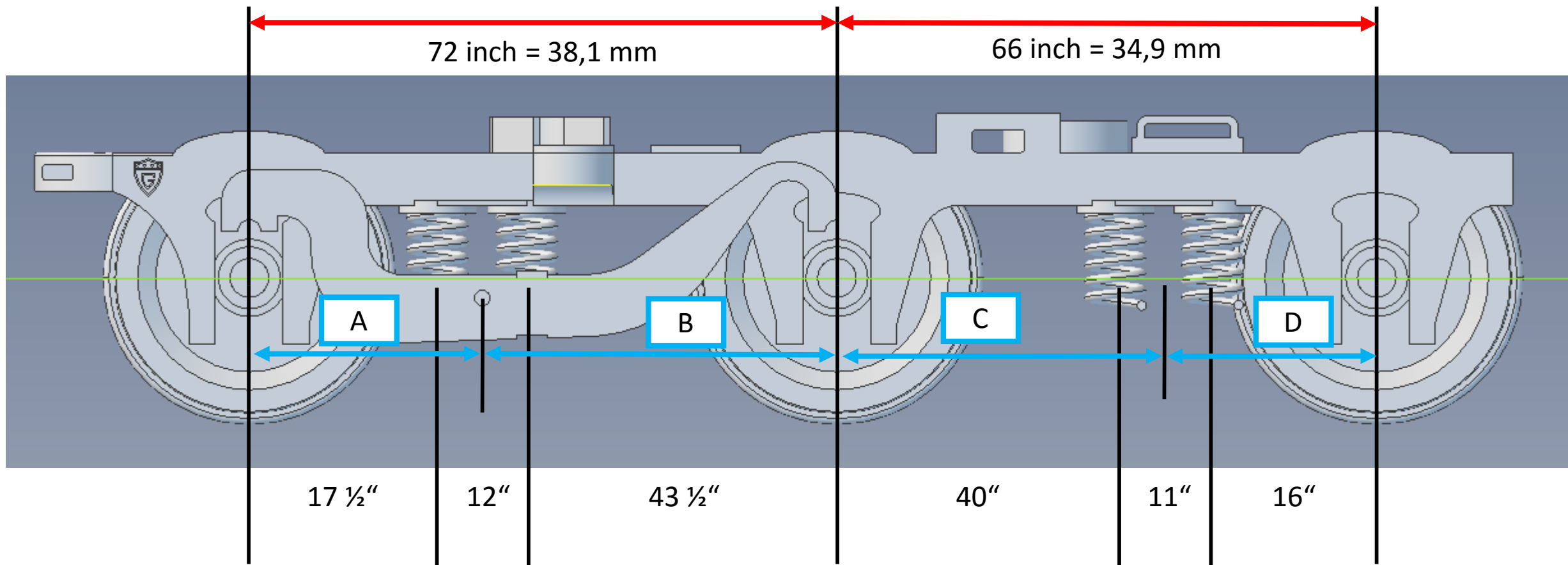

Data need to confirmed or modified: